



**titone**

**ambiente**

*towards excellence*



**THERMAL  
FOG AEROSOL**

Welcome to



**towards excellence**

### What is TIFONE.

**TIFONE Co.** was established in the 1955, as first manufacturer of Advanced Air Spraying Equipment for Orchard and Row Crops (at the times, spraying was made by hand-lances and long hoses hand thrown up to hundred meters on the ground, and in the mud, frequently).

In the 1965, TIFONE developed the "**CITIZEN-Line**", a family of Air Sprayers equipped with a special, innovative conception of full free pointing Spray - Cannon (**Flexigun**) for targeted Pest Vector Control and Environment Sanitation.

R&D and Production are 100% are based by TIFONE same, in Italy. TIFONE Customers are all over the world, in more than 100 countries. Continuous Innovation, Commitment and High Quality Standards make Company an outstanding player on the market.

Customer Care is a first aim, and a 24 Hour After Sale Service is guaranteed, to assist Customers in their everyday use of TIFONE equipment.

TIFONE is today leader in Italy and Europe in the Manufacturing of Equipment for Pest Vector Control.





## INDEX

**Thermal  
Fog Aerosol  
Project**



**p.04**

**Cannon  
Driven Fog**



**p.06**

**Add-On-10 L  
Fog Aerosol Generator**



**p.08**

**Fogger KB 12 - 44 LG**



**p.09**

**KART Fog KB 67 - 20 LG**



**p.10**

**Quad-Fog 67**



**p.11**

# Thermal Fog Aerosol

## Project



Low Temperature  
less than 170° C.



### What is Thermal Fog Aerosol?

TIFONE Thermal Fog Aerosol is the result of the generation of ultra-fine droplets (diameter 1-30  $\mu\text{m}$ ), by Thermo Energy. A powerful Air Cannon, as a positive Carrier, will provide to launch the Fog Aerosol at mid or large distance: 18 up to 50 metres, according to Cannon power-Oil based solutions, like Glycol Ethylene and similar, added with suitable liquid Formulates are forming the Fogging Mixture.

**Thermal Fog Aerosol, TIFONE "Air Cannon Driven" Emission.** Thermal Fogging is useful for any Pest Vector Control intervention, where active substances should be uniformly distributed, even in recessed and inaccessible areas, and with any or minimal residues.

**The TIFONE Thermal Foggers** are very Powerful, based on a thermal engine, Gasoline or Diesel, generating a high Fog Aerosol Output Capacity. The TIFONE Exclusive Long Range Air Cannon Facility are allowing a **positive, right to target**, emission. TIFONE Thermal Fog Aerosol do not damage the Active Formulates by heat, as:

- The maximum atomizing point temperature is 170° Celsius.
- The time period during which the Formulate remains in the hot gas stream is a fraction of a second.

### Application Fields of TIFONE THERMAL FOGGERS Aerosol "OUTDOOR" Pest Vector Control Intervention Areas:

- Public and Private Health = Malaria Mosquitoes, Dengue Mosquitoes, Encephalitis Mosquitoes, Flies, Wasps and other flying insects (Vectors) extermination.
- Sanitizing of areas from Diseases brought by insect, bacterial and fungus.
- Insect Control and Disinfecting of large Open Areas as Camping, Resort Areas, Canals, Private Areas as Parks, Gardens and Backyards.
- Sanitizing and Deodorizing of Composting plants/areas and manure-heaps.
- Deodorisation.
- Disinfestations and Sanitation of Disaster areas.
- Fruit and Row Crop Plantations, Forest, etc.
- Frost Preventing treatments.

### "INDOOR" Vector and Pest Control Intervention Areas:

- Disinfection and Insect Control in Poultry, Pork and Livestock Breeding and Stables.
- Sewerage lines treatment.
- Treatment in Silos, Warehouses, Stores.
- Treatment in Greenhouses.



**towards excellence**

# The TIFONE Thermal Fog Aerosol Equipment is available in 5 different Versions:



## CANNON DRIVEN THERMAL FOG

Specialized, Powerful, Large Autonomy, Long Range Cannon Driven Aerosol Fogger Unit Integrated version, Pick-up Carried.



## ADD-ON-10 L

A special Thermo-Fog Aerosol Generator kit that can be added to any Model of Pest Vector Control TIFONE Air Sprayer Citizen and City Line.



## FOGGER KB12-44 LG

Pick-up Carried Three Outlets Jets. Thermofogger in the Kart version. 4 wheel unit, to be used anywhere in town, in stores, etc.



## KART FOG KB 67-20 LG

Thermofogger in the Kart version. 4-wheel unit, to be used anywhere in town, in stores, etc.



## QUAD-FOG 67

QUAD Carried Units. The Quad Fog 67 can accede to any uneven terrain

# Cannon Driven Fog

## Innovative Aerosol Thermal Fogging Equipment

**Specialized, Powerful, Large Autonomy, Long Range Cannon Driven Aerosol Fogger Unit Integrated version, Pick-up Carried.**

### Main characteristics:

- “Cannon Driven” Emission, for a positive spray range and dispersion of the Aerosol Thermal Fog from 18 up to 50 m, according to Cannon power.
- Up to 100 metres by Air drift.
- The Cannon can be pointed in any direction, Horizontally and Vertically, by a remote control box (electric)
- A Wireless control box is also available.
- Flexigun Cannon Horizontal + 0-90° Vertical pointing facility
- Fogging Mixture Tank: 300 Litres, PE, with index contents meter.
- The unit is Pick-up loaded and unloaded in 30 sec.
- The Cannon Driven Emission Models are very versatile and can also allow the basic usual ways of treatment:
  - Aerosol Thermal Fogging, by Hand flexi-hose, for Warehouses, Greenhouses, Sewers, etc.
  - Aerosol Thermal Fogging Cup, for forcing the injection into drain covers (Sewers)
  - by Fog free Emission, in the Environment.



Drain Cup for forced emission.



Model	Motor HP	Emission controlled up to m	Tank Capacity l	Net Weight Kg	Dimensions L x W x H cm
<b>FD-KO-12 Diesel</b>	1 Cylinders / 12 HP	18	300	210	121 x 101 x 146
<b>FB-KA-13 Gasoline</b>	1 Cylinders / 13 HP	19	300	211	121 x 101 x 146
<b>FD-L-27 Diesel</b>	3 Cylinders / 27 HP	23	300	312	126 x 101 x 163
<b>FD-L-29 Diesel</b>	2 Cylinders / 29 HP	30	300	310	130 x 101 x 163
<b>FD-L-37 Diesel</b>	4 Cylinders / 37 HP	33	300	327	130 x 101 x 163
<b>FD-L-52 Diesel</b>	4 Cylinders / 52 HP	45	300	433	150 x 101 x 190

## **TRIPLE SPRAY Job:** Mist Sprayer + ULV Absolute Spray + Dry Thermal Fog

Any TIFONE Pest Vector Control Sprayer, equipped with ULV ABSOLUTE and FOG Aerosol Generator can perform the following spray treatments:

- **Wet Mist Spray** (80 Micron or other droplet sizes according to nozzles installed).

- **ULV (Ultra Low Volume, 20-30-40 Micron).**
- **Thermal Fog Spray**

**UNIQUE  
WORLDWIDE!**

## **The Spray Cannon killing 3-ways** From a Single Spray Unit, **3** Different Spray Modes

**1**  
**Cannon  
Mist  
Spraying**



**2**  
**Cannon  
Mist Spraying  
ULV Absolute**



**3** **Cannon Thermal Fog**



**TOTAL VECTOR EXTERMINATION**



# Add-On-10 L

## Fog Aerosol Generator



**A special Thermo-Fog Aerosol Generator kit that can be added to any Model of Pest Vector Control TIFONE Air Sprayer Citizen and City Line to convert a Thermal Fog High Performance Unit.**

- Fogging Mixture Tank: 8,6 Litres, PE.
- Max Flow Rate(Standard): according to model it will be added-on 4 G/hr (15 L/hr)
- Fogging Aerosol Emission Autonomy: according to model it will be added-on
- Aerosol Fog Blowing Range:
  - Cannon Driven emission:18 up to 35 m (according to model at which it is added-on), Drift Reach: up to 100 metres.
  - Hand pipe emission: according to use.
  - Free emission in the environment, Drift Reach up to 100 metres.
- Aerosol Fog Saturation Capability: according to model it will be added-on
- Dimensions, cm. L 18, W 36, H 42.  
Net weight, Kg. 15

### These Models are allowing three ways of treatment:



**1** Emission guided by a Long Range Cannon (of to model at which it is added-on), for targeted, intensive interventions.



**2** Drain Cup for forced emission.



**3** Free emission in the environment, for casual spreading and saturation.

# Fogger KB12 44 LG

## A special Thermo-Fog Aerosol Generator

- Pick-Up carried, engine 12 HP gasoline, to be used anywhere in town, in stores, etc.
- Fogging mixture tank 44 litres;
- Aerosol Fog Emission capability up to 1050 cubic /m per minute.
- Fogging Aerosol Emission autonomy up to 18 Hr.



### These Models are allowing three ways of treatment:



1 Fog by free Emission, in the Environment.



2 Fogging by Hand flexi-hose, for Warehouses, Greenhouses, Sewers, etc.



3 Fogging by Cup, for the forced injection into the drain covers (Sewers).

# Kart Fog KB 67 20 LG

## Thermal Fog Aerosol Large Outlets Jet

**Compact Autonomous Integrated in the Kart version, 4 wheels, Aerosol Fogger Unit for the Environment Disinfestation, Environment Restoration and Fast Deodorization.**

- Industrial KAMA, 1-cyl., 6,7 HP, gasoline, aircooled.
- Fogging Mixture Tank:  
20 Litres, PE.
- Flow Rate Emission (Standard) 2 G/h (7,56) L/h.
- Fogging Aerosol Emission Autonomy: up to 8 Hr.
- Aerosol Fog Blowing Range:
  - Hand pipe emission: According to use.
  - Free emission in the environment: Drifting Reach up to 100 metres.
- Aerosol Fog Emission capability: up to 900 cu/m per min.
- The unit is pick-up loaded and unloaded in 15 sec.
- Dimensions, cm. L 51, W 33, H 65.
- Net weight, Kg 37



### These Models are allowing three ways of treatment:



1

Fog by free Emission, in the Environment.



2

Fogging by Hand flexi-hose, for Warehouses, Greenhouses, Sewers, etc.

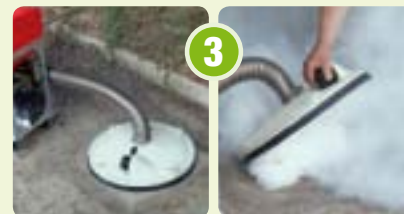

3

Fogging by Cup, for the forced injection into the drain covers (Sewers).

# Quad Fog 67

## Quad Carried Units Therma Fog Aerosol

The Quad Fog 67 can accede to any uneven terrain, it is easy to drive, safe and reliable and does not require any physical effort to the Operator.  
Fogging mixture tank 7 litres.  
Aerosol Fog Emission capability up to 900 cubic /m per minute.  
Fogging Aerosol Emission autonomy up to 3 Hr.

These Models are allowing three ways of treatment:

- Fogging by Hand flexi-hose, for Warehouses, Greenhouses, Sewers, etc.
- Fogging by free Emission, in the Environment.
- Fogging by Cup, for the forced injection into the drain covers (Sewers).



### Three emission mode:



Back side outlet.



Side outlet.



R+L outlet.



**towards excellence**

**Tifone Ambiente s.r.l.**  
via Modena, 248/A  
44124 Cassana - Ferrara - Italy  
Tel. +39 0532.730586 (r.a.)  
Fax +39 0532.730588  
tifone@tifone.com

**For additional information  
visit [www.tifone.com](http://www.tifone.com)**



## **SUMMARY OF TIFONE EXCELLENCE MAIN POINTS**

### **ELEVEN **11** Superior Advantages of TIFONE Exclusive “Cannon Driven” Thermal Foggers Aerosol.**

- 1** Three Emission Modes:
  - by Long Range Cannon
  - by Flexible Discharge Pipe and drain cup
  - by Free Emission
- 2** Right-to-target intervention.
- 3** Positive emission range: 18 to 50 meters.
- 4** Large Tank for a large Autonomy:  
from 6 to 40 hours continuously, according to model.
- 5** Large screen, high visibility, mechanical, precision mixture contents meter.
- 6** Electric Start.
- 7** Easy Fogging Control, Manual Operation with Remote Electric Control
- 8** Wireless Full Operation Control, for engine and Fogging (option)
- 9** Remote Electric Cannon Pointing Control. Wireless (option)
- 10** Easy Maintenance.
- 11** Manufacturer warranty.